

### Diffuse reflection

#### PD-F41UA

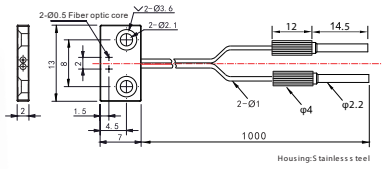
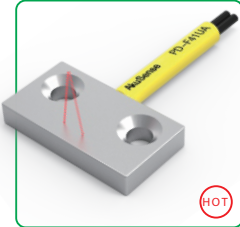

Sensing distance: PC1:80mm PG1:30mm  
 Minimum bending radius: R 2  
 Min- size D detected object: φ0 .05mm

**HOT**

#### PD-F42UA

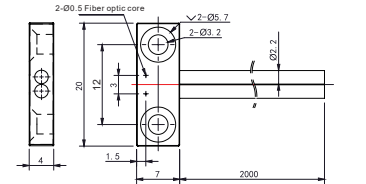
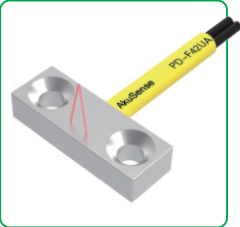

Sensing distance: PC1:160mm PG1:120mm  
 Minimum bending radius: R 2  
 Min- size D detected object: φ0 .05mm

#### PD-F44UA

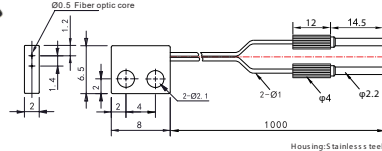

Sensing distance: PC1:120mm PG1:55mm  
 Minimum bending radius: R 2  
 Min- size D detected object: φ0 .05mm

#### PD-F47UA

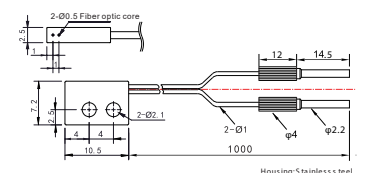
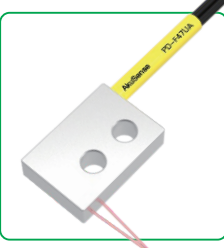

Sensing distance: PC1:80mm PG1:25mm  
 Minimum bending radius: R 2  
 Min- size D detected object: φ0 .05mm

### Thru-beam

#### PT-F51UA

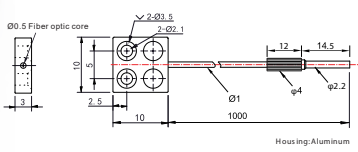
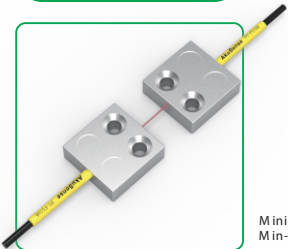

Sensing distance: PC1:400mm PG1:130mm  
 Minimum bending radius: R 2  
 Min- size D detected object: φ0 .05mm

#### PT-F52UA

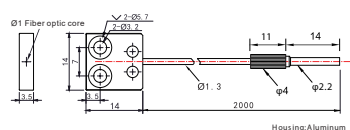
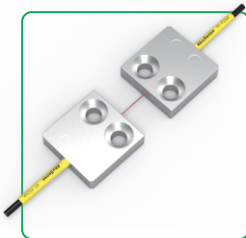

Sensing distance: 1900mm  
 Minimum bending radius: R 2  
 Min- size D detected object: φ0 .05mm  
 (Sensing distance varies with different amplifiers)

#### PT-F53UA

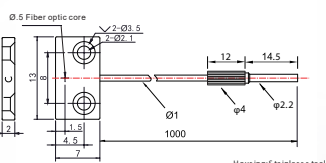
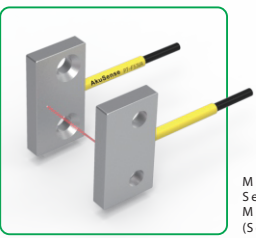

Sensing distance: PC1:210mm PG1:80mm  
 Minimum bending radius: R 2  
 Sensing distance: 340mm  
 Min- size D detected object: φ0 .05mm  
 (Sensing distance varies with different amplifiers)

#### PT-F54UA

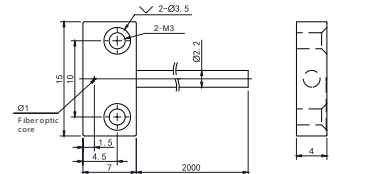
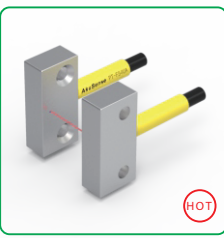

Sensing distance: PC1:1300mm PG1:450mm  
 Minimum bending radius: R 2  
 Min- size D detected object: φ0 .05mm

**HOT**

#### PT-F57UA

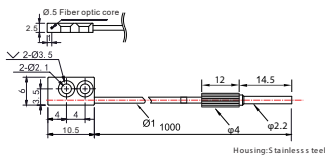
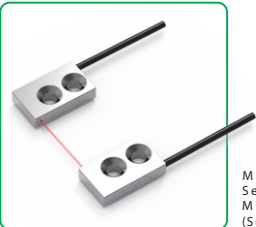

Sensing distance: PC1:100mm PG1:140mm  
 Minimum bending radius: R 2  
 Sensing distance: 480mm  
 Min- size D detected object: φ0 .05mm  
 (Sensing distance varies with different amplifiers)

#### PT-FZ8

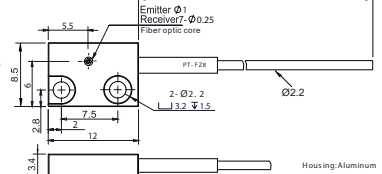
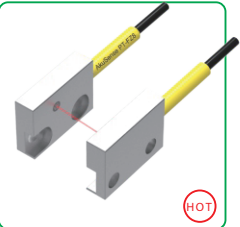

Sensing distance: 120mm  
 Minimum bending radius: R 15  
 Min- size D detected object: φ0 .1mm  
 (Sensing distance varies with different amplifiers)

**HOT**

### Fiber Optic

Slot Sensors

Photoelectric

Laser

Proximity

Displacement

Magnetic

Contact

Area

Ultrasonic

Vision

Vibration

Temperature

Annexes

Guidance

Fiber amplifiers

Standard economical

High stability

High performance type

High speed response

Fiber components

Popular type

Array-type

Flat bracket type

Side-view type

High elastic type

High temperature resistant

Small spot type

Combination type

High end type

Fiber lens

Fiber lens